

## **TEMPORARY EASEMENT FOR CONSTRUCTION**

KNOW ALL BY THESE PRESENTS:

That **Ankeny Community School District** hereinafter called "Grantor" in consideration of the sum of One Dollar (\$1.00) and other valuable consideration in hand paid by the **City of Ankeny**, Iowa upon final approval and acceptance of this easement do hereby convey unto the City of Ankeny, Iowa, a municipal corporation, in the County of Polk, State of Iowa, hereinafter called "Grantee", a temporary construction easement over, across and through the following described real estate:

See attached Exhibit

That said easement is granted unto the City of Ankeny, Iowa, for the purpose of the Access, construction, installation and maintenance of the following described public improvement:

### **ANKENY – HIGH TRESTLE TRAIL EXTENSION PROJECT**

In connection herewith it is specifically agreed that by this easement, the Grantee shall have the right to enter upon said premises as shall be necessary to construct, inspect, repair any and all of said improvements and all appurtenances thereto, together with the right to use and operate said improvements as it deems necessary.

The said Grantee shall restore said described land to a satisfactory condition after construction and/or repair as per plan.

This easement shall be for the period of time necessary to construct this improvement and will expire upon the date of final acceptance of the project by the City Council of the Grantee.

The Grantor does hereby covenant with said Grantee, and successors in interest, that said grantors hold said real estate by title and fee simple; that they have good and lawful authority to sell and convey the same; that said premises are free and clear of all liens and encumbrances whatsoever except as may be hereinabove stated; that said Grantor covenants to warrant and defend the said premises against the lawful claims of all persons whomsoever, except as may be above stated.

IN WITNESS WHEREOF we have hereunto affixed our hands this 7<sup>th</sup> day of January, 2018.

ANKENY COMMUNITY SCHOOL DISTRICT

[Signature] 1-7-19  
Authorized Signer Date  
School Board President

**SELLER'S ALL-PURPOSE ACKNOWLEDGMENT**

STATE OF Iowa }  
COUNTY OF Polk } ss:

On this 7<sup>th</sup> day of January, A.D. 2018, before me, the undersigned, a Notary Public in and for said State, personally appeared Lon Lovstad, of Ankeny Community School District.

X to me personally known

or        proved to me on the basis of satisfactory evidence to be the person(s) whose name(s) is/are subscribed to the within instrument and acknowledged to me that he/she/they executed the same in his/her/their authorized capacity(ies), and that by his/her/their signature(s) on the instrument the person(s), or the entity upon behalf of which the person(s) acted, executed the instrument.

(NOTARY SEAL)

[Signature] Sign in Ink  
Renae DeVenney (Print Name)  
Notary Public in and for the State of

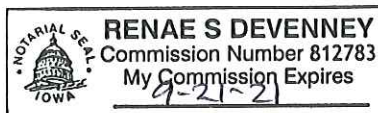

**CAPACITY CLAIMED BY SIGNER:**

       INDIVIDUAL  
       CORPORATE

Title(s) of Corporate Officer(s):

School Board President

       Corporate Seal is affixed

       No Corporate Seal procured

       PARTNER(s):

       Limited Partnership

       General Partnership

       ATTORNEY-IN-FACT

       EXECUTOR(s) or TRUSTEE(s)

       GUARDIAN(s) or CONSERVATOR(s)

       OTHER:

**SIGNER IS REPRESENTING:**

List name(s) of entity (ies) or person(s)

ANKENY COMMUNITY SCHOOL  
DISTRICT

**TEMPORARY EASEMENT DESCRIPTION:**

A PART OF LOT 1, ANKENY HIGH SCHOOL PLAT 1, AN OFFICIAL PLAT INCLUDED IN AND FORMING A PART OF THE CITY OF ANKENY, POLK COUNTY, IOWA, AND DESCRIBED AS FOLLOWS:

COMMENCING AT THE EASTERLY CORNER OF SAID LOT 1; THENCE NORTH 37°09'25" WEST ALONG THE EASTERLY LINE OF SAID LOT 1, A DISTANCE OF 100.72 FEET TO THE POINT OF BEGINNING; THENCE SOUTH 11°02'14" WEST, 99.09 FEET; THENCE NORTH 78°57'46" WEST, 50.00 FEET; THENCE NORTH 11°02'14" EAST, 143.80 FEET TO SAID EASTERLY LINE; THENCE SOUTH 37°09'25" EAST ALONG SAID EASTERLY LINE, 20.12 FEET; THENCE SOUTH 11°02'14" WEST, 108.95 FEET; THENCE SOUTH 78°57'46" EAST, 20.00 FEET; THENCE NORTH 11° 02' 14" EAST, 91.06 FEET TO SAID EASTERLY LINE; THENCE SOUTH 37°09'25" EAST ALONG SAID EASTERLY LINE, 20.12 FEET TO THE POINT OF BEGINNING AND CONTAINING 0.09 ACRES (4,072 S.F.).



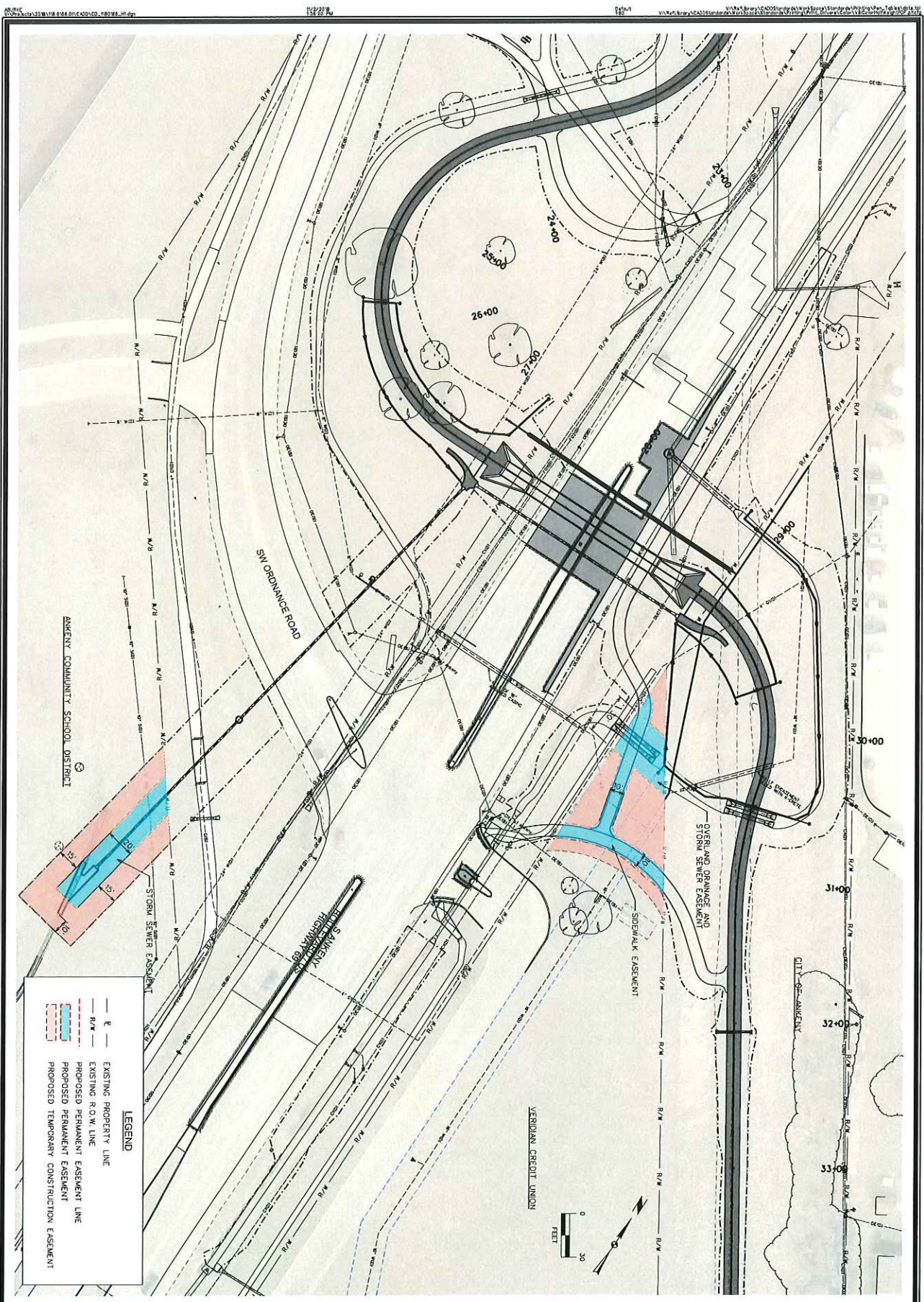

 <b>SNYDER &amp; ASSOCIATES, INC.</b> Project No.: 1180166 Sheet: H.1	<b>ANKENY- HIGH TRESTLE TRAIL EXTENSION</b> <b>RIGHT OF WAY</b>		<b>ANKENY, IOWA</b>	
	<b>SNYDER &amp; ASSOCIATES, INC.</b>			
	2727 S.W. SHYDER BLVD. ANKENY, IOWA 50023 515-984-2020   www.snyder-associates.com			
	MARK: _____ REVISION: _____ DATE: _____ BY: _____ Engineer: JDSH Checked By: AGB Scale: 1"= 30' Draftsman: DSS Date: 08/14/18 Field B/c: P/B			
Project No: 1180166		Sheet H.1		