

VICINITY MAP

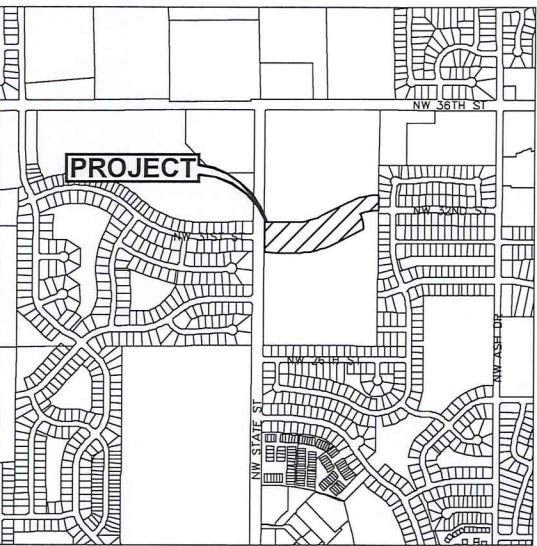

OWNER / APPLICANT

ROSE MARIE REINHART
655 NE 126TH AVE.
ALLEMAN, IA 50007

ZONING

EXISTING: R-1: ONE-FAMILY RESIDENCE DISTRICT
PROPOSED: R-3: RESTRICTED TO ONE-FAMILY AND TWO-FAMILY RESIDENTIAL DWELLINGS

REZONING DESCRIPTION

A PART OF THE WEST HALF OF THE NORTHWEST QUARTER OF SECTION 11, TOWNSHIP 80 NORTH, RANGE 24 WEST OF THE FIFTH PRINCIPAL MERIDIAN IN THE CITY OF ANKENY, POLK COUNTY, IOWA AND MORE PARTICULARLY DESCRIBED AS FOLLOWS:

COMMENCING AT THE NORTHEAST CORNER OF SAID WEST HALF OF THE NORTHWEST QUARTER; THENCE SOUTH THENCE SOUTH 00°17'35" WEST ALONG THE EAST LINE OF SAID WEST HALF OF THE NORTHWEST QUARTER, 988.70 FEET TO THE POINT OF BEGINNING; THENCE CONTINUING SOUTH 00°17'35" WEST ALONG SAID EAST LINE, 169.13 FEET; THENCE NORTH 89°45'02" WEST, 9.50 FEET; THENCE WESTERLY ALONG A CURVE CONCAVE SOUTHERLY WHOSE RADIUS IS 500.02 FEET, WHOSE ARC LENGTH IS 198.43 FEET AND WHOSE CHORD BEARS SOUTH 78°52'52" WEST, 197.13 FEET; THENCE SOUTH 22°29'15" EAST, 33.37 FEET; THENCE SOUTHERLY ALONG A CURVE CONCAVE WESTERLY WHOSE RADIUS IS 333.02 FEET, WHOSE ARC LENGTH IS 132.15 FEET AND WHOSE CHORD BEARS SOUTH 11°07'08" EAST, 131.29 FEET; THENCE SOUTH 00°14'58" WEST, 4.40 FEET; THENCE SOUTH 63°13'01" WEST, 319.36 FEET; THENCE SOUTH 63°13'09" WEST, 47.00 FEET; THENCE SOUTH 65°06'22" WEST, 53.73 FEET; THENCE SOUTH 68°39'28" WEST, 53.50 FEET; THENCE SOUTH 72°12'06" WEST, 53.50 FEET; THENCE SOUTH 75°44'44" WEST, 53.50 FEET; THENCE SOUTH 79°17'22" WEST, 53.50 FEET; THENCE SOUTH 82°49'60" WEST, 53.50 FEET; THENCE SOUTH 86°22'38" WEST, 53.50 FEET; THENCE SOUTH 89°35'07" WEST, 50.81 FEET; THENCE NORTH 89°46'25" WEST, 356.33 FEET TO THE EAST RIGHT OF WAY LINE OF NW STATE STREET; THENCE NORTH 00°16'12" EAST ALONG SAID EAST LINE, 335.02 FEET; THENCE SOUTH 89°41'28" EAST, 338.56 FEET; THENCE SOUTH 89°48'31" EAST, 45.00 FEET; THENCE NORTH 87°06'34" EAST, 39.88 FEET; THENCE NORTH 82°47'16" EAST, 40.81 FEET; THENCE NORTH 78°25'00" EAST, 40.81 FEET; THENCE NORTH 74°02'44" EAST, 40.81 FEET; THENCE NORTH 69°40'29" EAST, 40.81 FEET; THENCE NORTH 65°17'59" EAST, 40.90 FEET; THENCE NORTH 63°13'01" EAST, 360.21 FEET; THENCE NORTH 65°03'51" EAST, 52.49 FEET; THENCE NORTH 69°36'28" EAST, 53.44 FEET; THENCE NORTH 74°12'47" EAST, 53.44 FEET; THENCE NORTH 78°49'06" EAST, 53.44 FEET; THENCE NORTH 83°25'26" EAST, 53.44 FEET; THENCE NORTH 88°19'55" EAST, 64.05 FEET TO THE POINT OF BEGINNING AND CONTAINING 9.43 ACRES (410,781 SQUARE FEET).

THE PROPERTY IS SUBJECT TO ANY AND ALL EASEMENTS OF RECORD.

ADJACENT OWNERSHIP

	OWNER	ACRES	PERCENT	CONSENTING
1	FIELDSTREAM APARTMENTS	1.14	5.08%	
2	ROSE MARIE REINHART	15.76	70.28%	X
3	SEGAR TRAVIS J & TOPP-SEGAR JENNIFER A	0.20	0.89%	
4	HUSTON KELLY M & KATHRYN E	0.02	0.09%	
5	CITY OF ANKENY*	-	-	
6	STOCKWELL DENNIS & TINA	0.25	1.11%	
7	SNYDER BENJAMIN M & NICOLE SARA	0.23	1.03%	
8	A'HEARN BENJAMIN M & AMY B	0.22	0.98%	
9	FORRESTER AARON C & EMILY J	0.29	1.29%	
10	MILLER ERIC & AMY	0.22	0.98%	
11	TAYLOR JOSHUA W	0.20	0.89%	
12	MADISON JON M & PATTI A	0.00	0.00%	
13	MEYER JOHN & NICOLE S	0.05	0.22%	X
14	ARMOUR CHAD & ANGELA	0.01	0.04%	X
15	MORALES ARTURO J & MELANIE A	0.04	0.18%	
16	BUSCHOW JASON R & CATHERINE L	0.19	0.85%	
17	SWENSON AARON P & MALLORY J	0.39	1.74%	
18	PLOEGER WARREN E	0.21	0.94%	
19	PORT SCOTT & ERIN	0.16	0.71%	
20	PARKER JON	0.14	0.62%	
21	MCKENNA MARK R & DANAT	0.07	0.09%	
22	SCHIEBEL DAVID D & ANGELA K	0.15	0.67%	
23	TESDALL JOHN & KRISTIN	0.63	2.81%	
24	HADLEY STEVEN B & KARA E	0.40	1.78%	
25	JETMUND JON T & DEBRA A	0.00	0.00%	
26	ROJAS-BOLANOS MARIELOS	0.15	0.67%	
27	JONES MICHAEL E & AMY K	0.25	1.11%	
28	BRADOUR BRIAN & JILLIAN	0.35	1.56%	
29	GOSLINGA TED C & DEANNA R	0.35	1.56%	
30	GRIEME KENDALL W & NORELLUS AMANDA D	0.24	1.07%	
31	GUGGER TRACY W	0.17	0.76%	X
TOTAL		22.43	100.00%	71.29%

*CITY OF ANKENY PROPERTIES ARE NOT INCLUDED IN THE AREA PERCENTAGES.



FILE: H:\2019\1811590\DWG\1811590-REZONING-1.DWG
FILE DATE: 3/12/19 DATE PLOTTED: 3/14/2019 3:02 PM